

## Pressure Manhole PN1-PN3



### Product Introduction

Material: SS304, SS316L

Pressure Range: 0.1-0.3MPa (higher pressure can be customized on request)

Surface Finish: mirror polish, matt polish

Features: quick opening style, nice and practical design

Applications: food tanks, pharmaceutical tanks, chemical tanks, etc

Size Range: DN150-DN600

### Parts List

No.	Description	Material	Quality
1	Frame	304 / 316L	1
2	Cover	304 / 316L	1
3	Gasket	Silicone	1
4	Handwheel	SS304 / ABS / Ring	4-8
5	Hub	304	1
6	Screw	304	1
7	Swing Bolt	304	4-8
8	Pin	304	4-8
9	Lock Ring	304	4-8
10	Nut	304	1
11	Upper Hinge	304	1
12	Lower Hinge	304	1
13	Handle	304	1

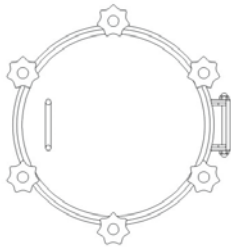
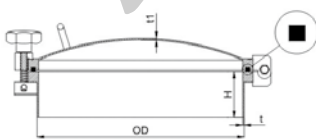
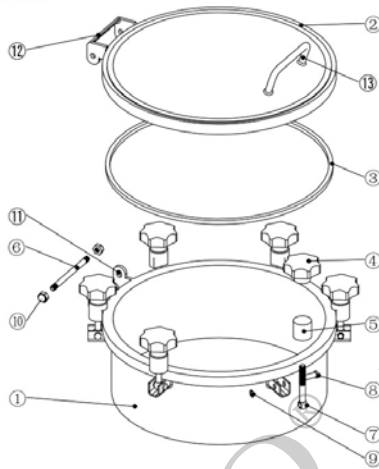

JOF-MHR003-02

### Dimensions

Size	OD	H	t	t1	Handwheel Qty	Pres(Bar)
150	156	100	3	2.5	4	1-3
200	206	100	3	2.5	4	1-3
250	256	100	3	2.5	4	1-3
300	306	100	3	2.5	5	1-3
350	356	100	3	2.5	6	1-3
400	406	100	3	2.5	6	1-3
430	436	100	3	3	6	1-3
450	456	100	3	3	6	1-3
500	506	100	3	3	6	1-3
600	606	100	3	3	8	1-3

The height (H) and collar (t) can be customized on request